



**Chicago  
Pneumatic**



**Built to last!**

**Hydraulic breakers**

# RX means R-liable to the X-treme

## Rugged and hard-hitting

Don't be fooled by their attractive, streamlined design, RX hydraulic breakers are reliable with all the power you need to get the job done, and more. They are also rugged and built to last. Attach the right RX breaker to the carrier of your choice, and power your way through the job in no time.

## These breakers will do the job

The smart design of RX hydraulic breakers with few parts and only two moving parts, offers a high grade of availability and reliability. On the small and medium-sized RXs there are no expensive high-pressure accumulators or filling

devices to worry about either. The aim of this smart design is to provide breakers that will handle the toughest jobs, in all weathers, without complaining and go on doing the job – year in, year out.

## Noise reduced means: less trouble with the neighborhood on the job site.

Thanks to the RX recoil absorbing concept and the polyurethan insulated breaker box system, RX breakers are amongst the most silent breakers and in line with the outdoor equipment directive 2000/14/EU.

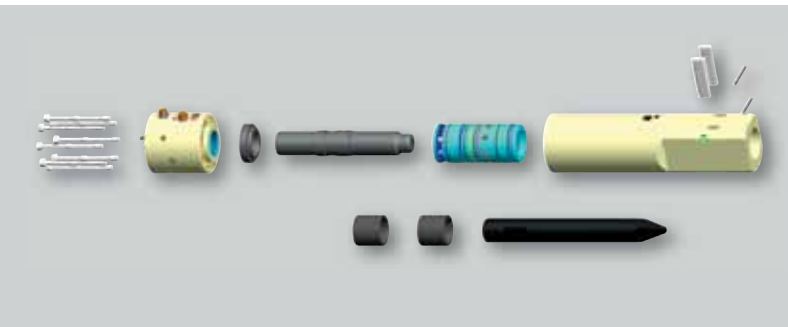

### RX hydraulic breakers (RX2 – RX22)

These RX breakers have fewer parts and only two moving parts – no high pressure accumulator, less sources for failures. They are easy to maintain, service and repair – no multi torque wrench needed.\*

### RX hydraulic breakers (RX25 – RX53)

Due to technological barriers these breakers are designed with side bolts but with cutting edge technology fasteners – head bolts with insert threads and no nuts.

\* Not RX11

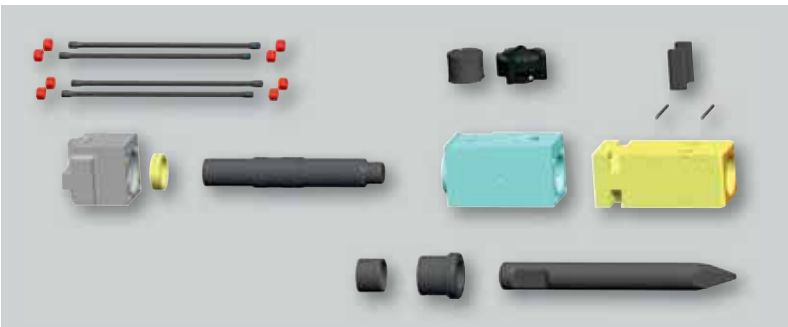

### Traditional breaker technology with 4 side bolts and nuts

The traditional hydraulic breaker that has been around for decades is complex with many parts.

# Value-for-money features

## Power booster – for maximum performance

The power booster feature on RX breakers enables you to get higher breaking performance without increasing the hydraulic input in tougher breaking applications. While the impact energy remains constant, the breaker increases the blow frequency, which results in increased percussive performance.

## Power Stop function – to protect your investment

This feature reduces blank firing, thus helping to protect breaker and carrier while increasing the lifetime of the components.

## Power control valve – to increase productivity

RX breakers (from RX25 upwards) are equipped with a power control valve. This feature enables you to set the breaker characteristics according to the application – for higher productivity.

## High impact, low noise

RX breakers are prepared for the future as they already comply with current and future regulations stipulated in Noise Emission of Outdoor Equipment Directive 2000/14/EC.

## No side bolts (RX2 – RX22\*)

This feature makes RX breakers even more reliable, because non existing parts can simply not fail...

Even better: opening a breaker for resealing can be done with ordinary hand tools.

## Cutting edge side bolts system (RX25 – RX53)

This innovative fastener system with head bolts and insert threads distributes the thread strain equally.

## Dust wiper (optional, from RX14 upwards)

This feature helps to increase the lifetime of your wear components. Simple and reliable – it keeps abrasive dust out and the grease in.

## CP-Lube – automatic lubrication (optional)

Breaker models from RX14 upwards can be equipped with CP-Lube. This feature ensures optimal lubrication of the wear bushings and the working tool and thus avoids unnecessary downtime.

\* Not RX11

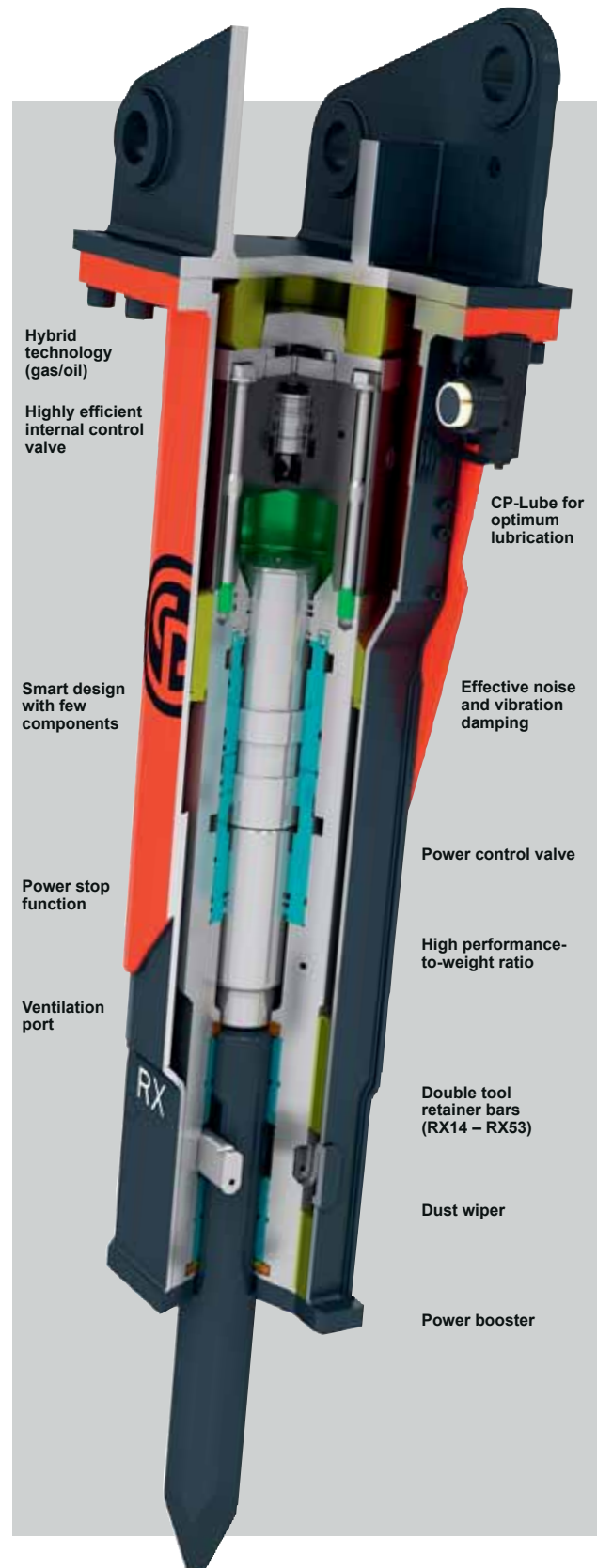



# Innovative, own breaker technology



## A great brand since more than 100 years

Chicago Pneumatic has been a well known brand since 1901. Today we are a globally acting company providing a wide range of high-quality tools for the construction, demolition and mining industry

## Extensive investments in R&D

The innovative technology, unique design and value-for-money features of the RX hydraulic breaker range are the direct result of extensive investments in R&D.

## Worldwide customer support

Buying an RX breaker is just the beginning. Chicago Pneumatic distributors offer reliable service support. Genuine spare parts for your RX breaker are available worldwide, with short delivery times.



# Thirteen breakers at your service

Model	Service weight		Carrier weight class		Operating pressure		Oil flow rate		Blow frequency	Working tool diameter		Sound power level	Part no.
	kg	lb <sup>1)</sup>	t	lb <sup>2)</sup>	bar	PSI	l/min	gpm	bpm	mm	in	dB(A)	
<b>RX2</b>	117	258	1,3-3,0	2,900-6,600	110-130	1,600-1,890	15-35	4-9	560-1700	42	1.65	109 <sup>4)</sup> /81 <sup>5)</sup>	8460 0500 38
<b>RX3</b>	166	366	2,1-4,5	4,600-9,900	110-140	1,600-2,030	30-50	8-13	670-1450	52	2.04	111 <sup>4)</sup> /83 <sup>5)</sup>	8460 0500 39
<b>RX4</b>	233	514	2,9-6,0	6,400-13,200	110-140	1,600-2,030	35-60	9-16	520-1150	62	2.44	113 <sup>4)</sup> /85 <sup>5)</sup>	8460 0500 40
<b>RX6</b>	284	626	4,2-9,0	9,300-19,800	110-140	1,600-2,030	45-75	12-20	530-1150	70	2.75	114 <sup>4)</sup> /86 <sup>5)</sup>	8460 0500 41
<b>RX8</b>	380	838	5,2-12,0	11,500-26,500	120-150	1,740-2,180	60-90	16-24	530-1050	80	3.14	115 <sup>4)</sup> /87 <sup>5)</sup>	8460 0500 42
<b>RX11</b>	550	1,210	9-15	19,800-33,100	120-150	1,740-2,180	70-100	18-26	590-1100	80	3.14	116 <sup>4)</sup>	3363 1095 21
<b>RX14</b>	800	1,760	10-17	22,000-37,500	150-170	2,180-2,470	100-120	26-32	650-850	100	3.93		3363 1049 61
<b>RX18</b>	1200	2,650	15-24	33,100-52,900	150-170	2,180-2,470	120-140	32-37	550-720	120	4.72		3363 1052 39
<b>RX22</b>	1500	3,310	17-28	37,500-61,700	150-170	2,180-2,470	140-160	37-42	520-680	135	5.31		3363 1051 01
<b>RX25</b>	1800	3,970	20-33	44,100-72,800	150-170	2,180-2,470	130-180	34-48	400-680 (460-800) <sup>3)</sup>	140	5.51		3363 1056 01
<b>RX29</b>	2200	4,850	25-40	55,100-88,200	150-170	2,180-2,470	150-200	40-53	375-600 (400-800) <sup>3)</sup>	150	5.90		3363 1058 93
<b>RX45</b>	3000	6,610	29-46	63,900-101,400	160-180	2,320-2,610	210-260	55-69	380-580 (-) <sup>3)</sup>	165	6.49	121 <sup>4)</sup> /91 <sup>5)</sup>	3363 1053 59
<b>RX53</b>	4200	9,260	40-70	88,200-154,300	160-180	2,320-2,610	250-320	66-85	350-560 (-) <sup>3)</sup>	180	7.08		3363 1097 39

<sup>1)</sup>Breaker and breaker box with standard adapter plus working tool.

<sup>2)</sup>Weights apply to standard carriers only. Any variances must be agreed with Chicago Pneumatic and/or the carrier manufacturer prior to attachment.

<sup>3)</sup>Power Control: The blow frequency and impact energy can be adjusted to better meet the application requirements.

<sup>4)</sup>Sound power level guaranteed.

<sup>5)</sup>Sound pressure level (r=10m).

**Important:** EN ISO 3744 in accordance with directive 2000/14/EC. Full details of measurement are available in the Safety and Operating Instruction of the product.

## RX hydraulic breakers – features at a glance

- Hybrid technology (gas/oil)
- Innovative design with less components
- Effective noise and vibration damping
- Highly efficient internal control valve
- Power booster
- Power stop function
- Power control valve\*
- Ventilation port\*\*
- Dual retainer bars\*\*

## Optional extras

- Field replaceable wear bushing (RX2 – RX11)
- CP-lube for optimum grease distribution
- HD Kit\*
- Dust wiper\*\*

\* From RX25 upwards

\*\* From RX14 upwards

